

Plain face flanges for brazing or welding
Nominal pressure 6

DIN
2573

Flansche, glatt zum Löten oder Schweißen; Nenndruck 6

As it is current practice in standards published by the International Organization for Standardization (ISO), the comma has been used throughout as a decimal marker.

Dimensions in mm

Standard design

Type A Joint face: no requirements specified

Type B Joint face $R_z = 160$, turned

Design to be used in shipbuilding

Type AS Joint face: no requirements specified

Type BS Joint face $R_z = 160$, turned

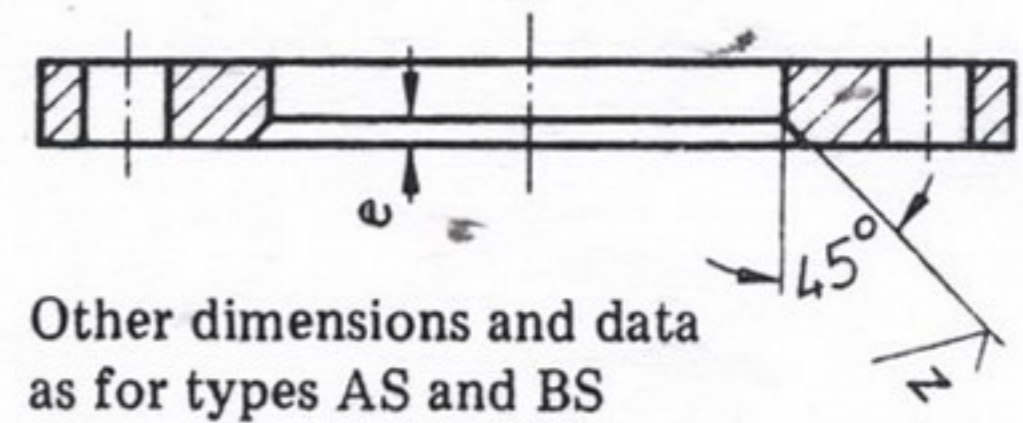
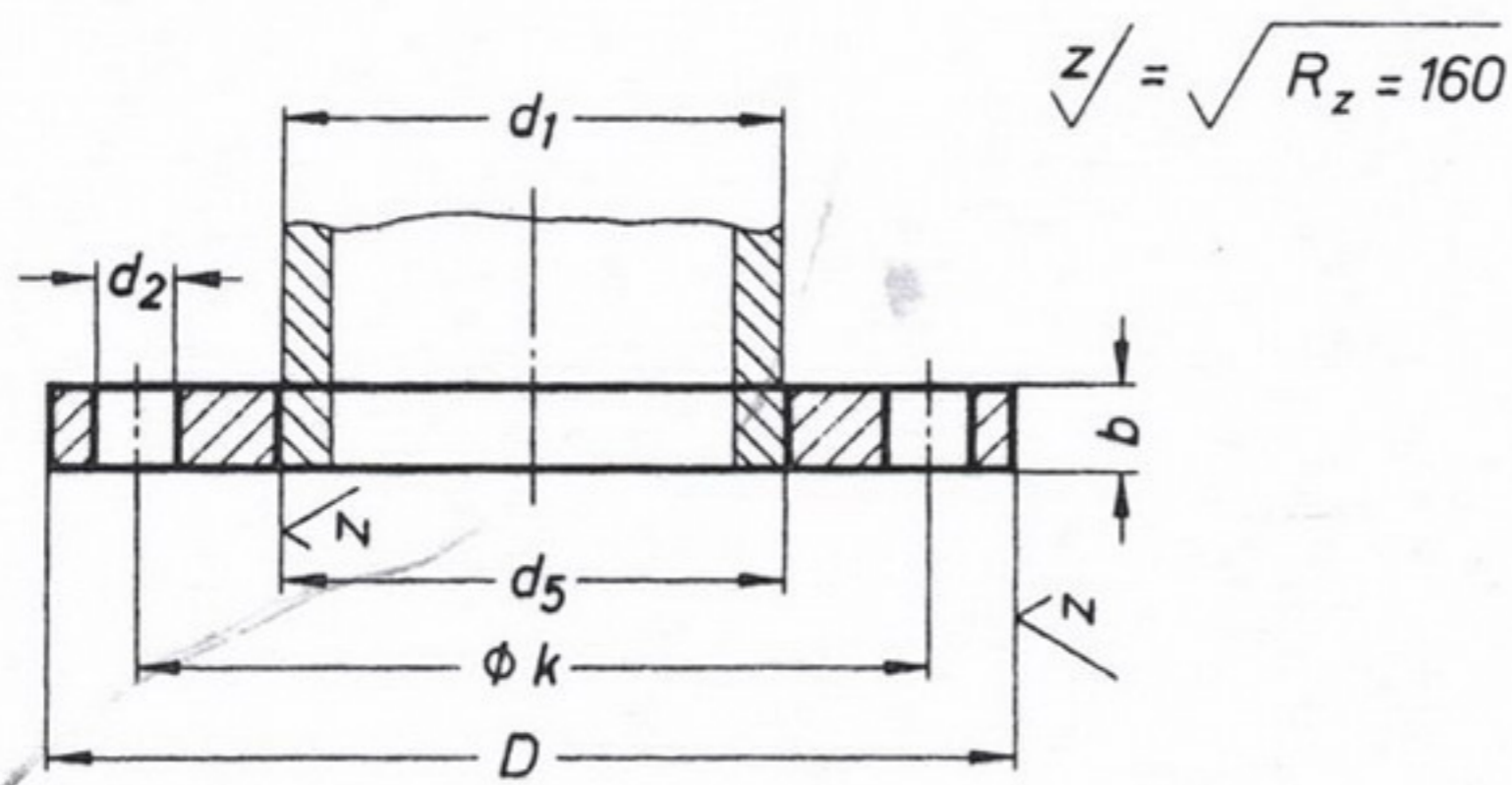

Designation of a type A plain face flange for an RSt 37-2 pipe of nominal size 100 and with outside diameter $d_1 = 114,3$ mm:

Flange A 100 × 114,3 DIN 2573 — RSt 37-2

Examples of pipe/flange connections

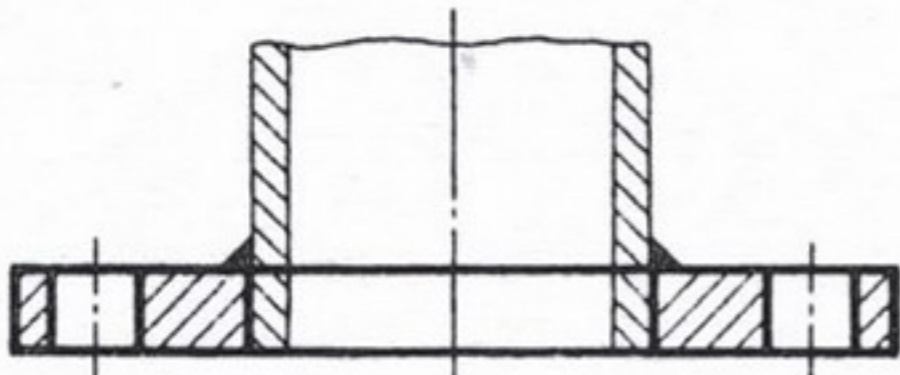

For brazing

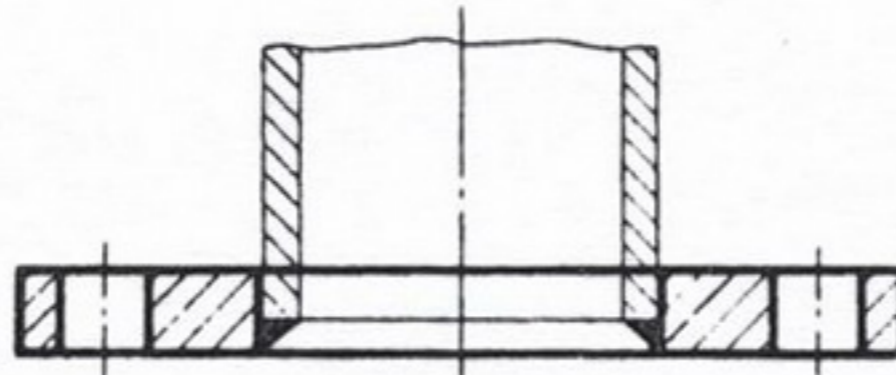

For welding

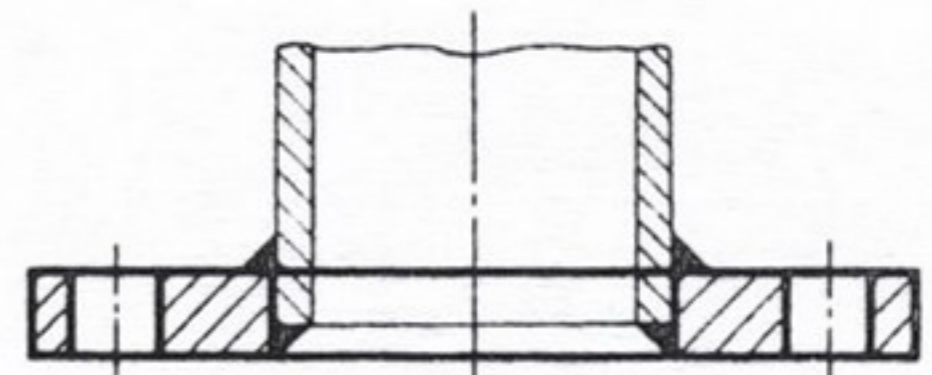

For welding thick-walled pipes

Examples of AS and BS flange connections

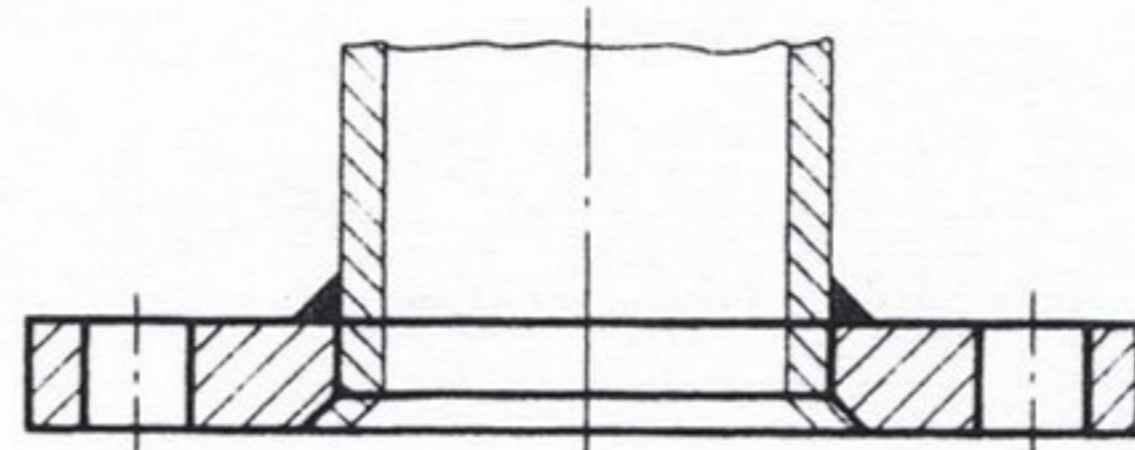
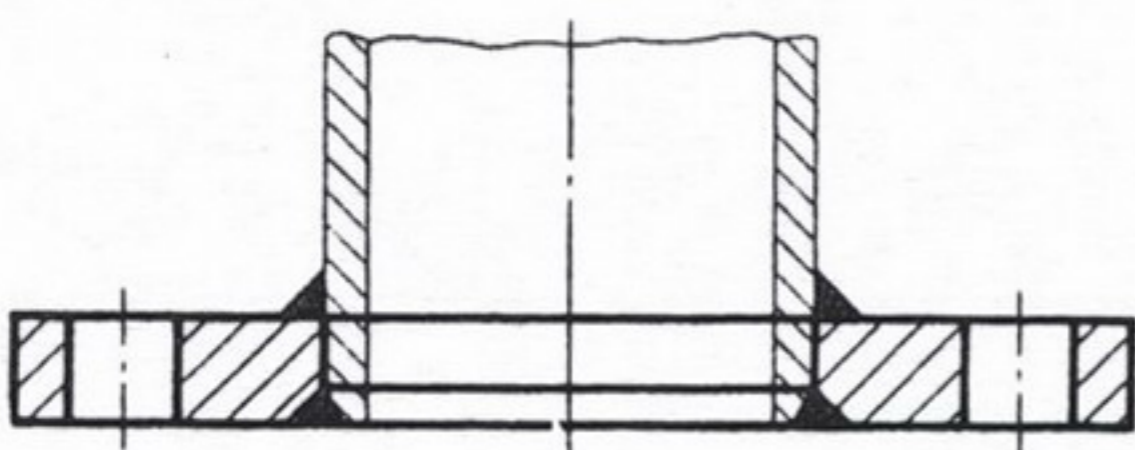

Continued on page 2

鋼管及鋼管接頭之規格，僅在德國使用。

Nominal size	Pipe connecting dimensions		Flange				Bolts			Weight of a flange (7,85 kg/dm ³) kg ≈	
	Series 1	Series 2	d_5	D	b	e	k	Number	Thread		d_2
10	—	14	14,5	75	12	5	50	4	M 10	11	0,363
	17,2	—	17,7								
15	—	20	21	80	12	5	55	4	M 10	11	0,410
	21,3	—	22								
20	—	25	26	90	14	5	65	4	M 10	11	0,600
	26,9	—	27,6								
25	—	30	31	100	14	5	75	4	M 10	11	0,740
	33,7	—	34,4								
32	—	38	39	120	16	5	90	4	M 12	14	1,19
	42,4	—	43,1								
40	—	44,5	45,5	130	16	5	100	4	M 12	14	1,39
	48,3	—	49								
50	—	57	58,1	140	16	6	110	4	M 12	14	1,53
	60,3	—	61,1								
65	76,1	—	77,1	160	16	6	130	4	M 12	14	1,89
80	88,9	—	90,3	190	18	7	150	4	M 16	18	2,98
100	—	108	109,6	210	18	7	170	4	M 16	18	3,46
	114,3	—	115,9								
125	—	133	134,8	240	20	7	200	8	M 16	18	4,60
	139,7	—	141,6								
150	—	159	161,1	265	20	7	225	8	M 16	18	5,22
	168,3	—	170,5								
200	219,1	—	221,8	320	22	7	280	8	M 16	18	7,15
250	—	267	270,2	375	24	7	335	12	M 16	18	9,61
	273	—	276,2								
300	323,9	—	327,6	440	24	7	395	12	M 20	22	12,6
350	355,6	—	359,7	490	26	7	445	12	M 20	22	15,6
	—	368	372,2								
400	406,4	—	411	540	28	7	495	16	M 20	22	18,4
	—	419	423,7								
(450)	457	—	462,3	595	30	7	550	16	M 20	22	21,4
500	508	—	513,6	645	30	7	600	20	M 20	22	24,6

Bracketed nominal size should be avoided wherever possible.

Series 1 pipe connecting dimensions are specified in international standards, the series 2 connecting dimensions are only used in Germany.

Material: RSt 37-2 as specified in DIN 17 100 (other materials must be agreed)

RSt 37-2 flanges having the dimensions specified in this standard may be subjected to temperatures not exceeding 120 °C at operating pressures equal to the nominal pressure. For temperatures between 120 °C and 300 °C a decrease in the yield strength shall be taken into account.

Manufacturing process, condition at supply and marking in accordance with DIN 2519

Other relevant standards

DIN 2448 Seamless steel pipes and tubes; dimensions, conventional masses per unit length

DIN 2458 Welded steel pipes and tubes; dimensions, conventional masses per unit length

DIN 2500 Flanges; general information, survey

DIN 2519 Steel flanges; technical delivery conditions